

2020 Conference Exhibits



WASHINGTON
SCHOOL
NUTRITION
ASSOCIATION

July 28, 2020

**SPOKANE CONVENTION CENTER WEST
SPOKANE, WASHINGTON**

Exhibitor Prospectus Look inside for...

Exhibit Details	2
Exhibit Hall Diagram.....	3
Sponsorships.....	4
Other Sponsorships	4-5
Service Kits	5
Electrical Service.....	5
Hotels.....	5
Silent Auction	5
Advertising Opportunities	5
Door Prizes.....	5
Official Decorator	5
Terms & Conditions.....	6
Application/Contract	7
2019 Exhibitors	8

Renew Relationships and Foster New Ones

The Washington School Nutrition Association's Conference Exhibits provide an opportunity for you to promote your products and services to nearly 500 WSNA and SNA members, many of whom are potential buyers. The networking opportunity is invaluable.

Reserve Your Space Today!

Complete the application form on page 7 and return it to the address listed on the form. If you have questions, contact WSNA Executive Director Marianne Culligan, 206.714.5832, waschoolnutrition@gmail.com.

Exhibit Details

Date: Tuesday, July 27, 2020

Location: Spokane Convention Cntr West
Spokane, Washington

Booth Size: Single booths: 10' W x 10' D
Multiple booths are available

Theme: *2020 Vision: Bringing Nutrition Services into Focus*

Cost:

Early Bird Special	\$1,050
Register and pay by May 10, 2020	
After May 10, 2020	\$1,100
Non-profit Early Bird	\$300
Register and pay by May 10, 2020	
Non-profit after May 10, 2020	\$350

Exhibitor Set-up Hours:
Monday, July 27, 2020 11 am - 5 pm

Night of Entertainment:
Monday, July 27, 2020 6 pm - 9:30 pm
(Two attendees per booth)

Exhibit Hall Hours:
8:30 am to 2:00 pm:
8:30 am - 10:30 am:
Directors & Supervisors ONLY
10:30 am - 2 pm:
All Attendees

Exhibit Dismantling Hours:
Tuesday, July 29, 2020
2:00 pm to 6:00 pm
(No early breakdowns; it is dangerous for attendees and appears unprofessional.)

Exhibit Package:

- Standard booth setup, including 8' high back drape and 3' high draped side rails
- Complimentary sign (one per booth) listing company name
- Complimentary 8' draped table with two chairs and a waste basket
- Security service overnight Monday and during exhibit hours
- Refrigeration/freezer service & ice on site
- Two (2) complimentary NOE tickets per booth

Payment

Space request must be made on the official Application/Contract for Exhibit Space and is to include a 20-word maximum description of your product(s) or service(s) to assist in booth assignment. **Full payment of the contracted space must be made by May 10, 2020, in order to purchase booth space at the Early Bird rate.** After priority is given to Platinum Sponsors (paid by 4/30/20), booth space is assigned on a first-come/first-served basis. Please refer to the terms and conditions for the cancellation clause.

FULL PAYMENT MUST BE MADE BEFORE AN EXHIBITOR WILL BE ALLOWED TO SET UP BOOTH.

16th Annual Booth Decorating Contest

This year's conference theme is *2020 Vision: Bringing Nutrition Services into Focus*, so it's time to be creative and decorate your booth accordingly.

Judging information will follow in your confirmation packet.

Diagram of Exhibit Hall

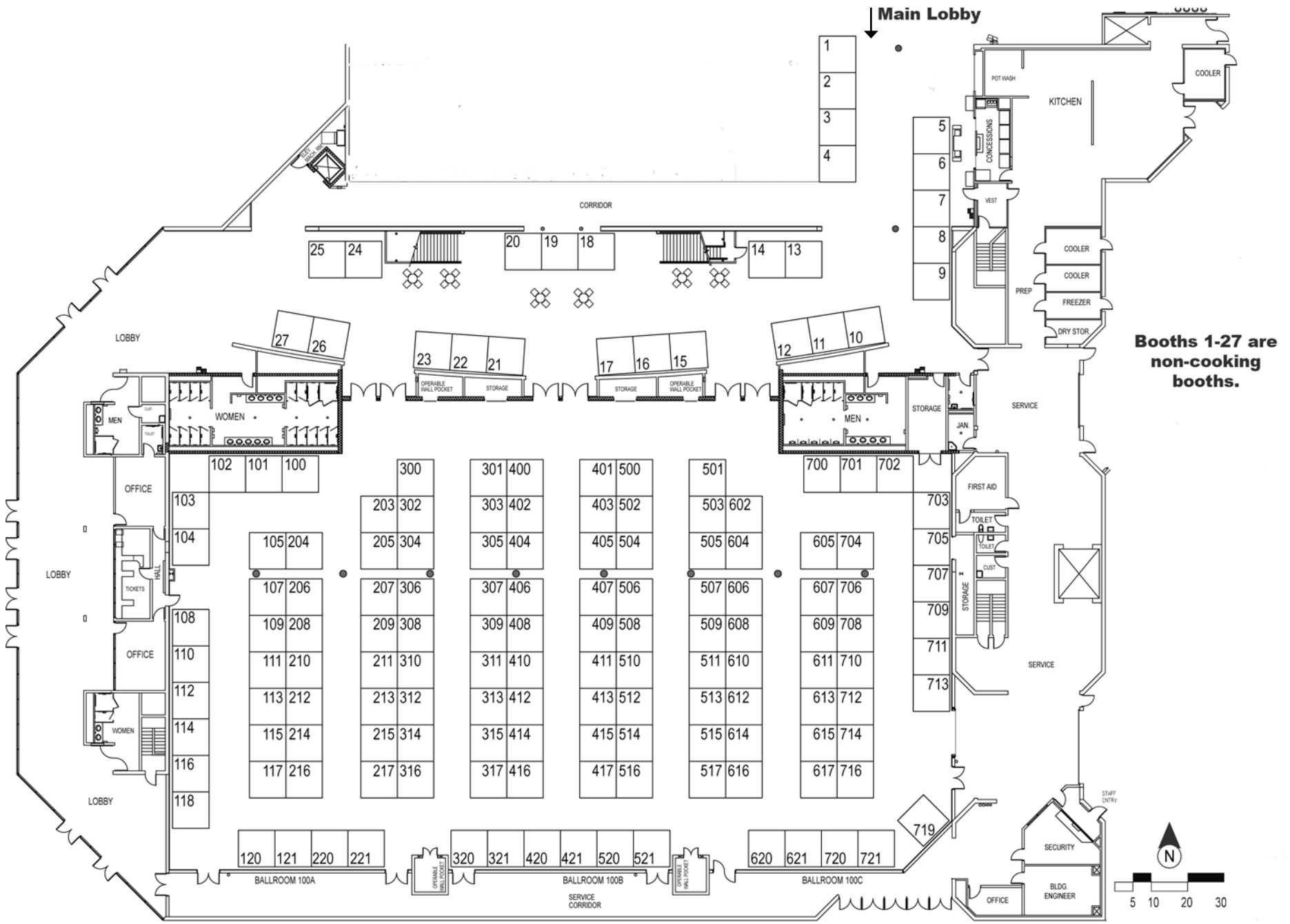

Booths 1-27 are non-cooking booths.

WSNA 2020 Sponsorship Opportunities

Check the appropriate box on the Exhibit Space Application/Contract and include the price of sponsorship with your registration fees. If you have any questions contact Executive Director Marianne Culligan, 206.714.5832, waschoolnutrition@gmail.com.

Platinum Sponsor ~ \$3,800 (Includes one Exhibit Booth)

- Exhibit booth at Annual State Conference with special signage and floor decals (New!). (\$1,080 Value) (Preferred choice of booth location if sponsorship paid by 3/31/2020.)
- Half-page color ad (or equivalent) in ALL (4) issues of the Apple Press. (\$1,180 value)
- Full-page ad in conference program. (\$100 value)
- Two President's Banquet tickets and recognition at President's Banquet. (\$120 value)
- Display table at Fall & Spring Workshops
- Corporate Membership for 1 year (up to 6 people; \$160 Value)
- Listed as a Platinum Partner on signage and programs at all events through the year.
- One registration with display table at Industry Seminar (\$150 value)
- Listed in all (4) issues of the Apple Press as a Platinum Partner.
- Listed in conference program book as a Platinum Partner
- Listed on WSNA's website with active link to your website.

Conference & Education Fund Sponsorships

Recognition for all Conference Sponsorships

All conference sponsors will be recognized in the conference program book, on the WSNA website, in the fall issue of the *Apple Press*, with special signage during exhibits, and on signage at the sponsored event. See description of each opportunity for other benefits.

Level 1 Sponsorships (\$300 - \$499):

In addition, sponsors will receive a quarter-page black-and-white program book ad (\$50 value), 1 President's Banquet ticket (\$60 value), and recognition at the President's Banquet.

Bronze Education Fund Sponsor \$300

Silver Education Fund Sponsor \$400

Funds are used for the education of members.

Promotional Inserts (5 available) \$300

Sponsor provides one promotional item (may be imprinted with the sponsor's logo) to be inserted in the conference bag. (Items are not included in the sponsorship fee).

Wellness Events Sponsor (3 available) \$300

Sponsor provides recognition items for participants in Conference wellness events.

Level 2 Sponsorships (\$500 - \$999)

In addition, sponsors will receive a half-page black-and-white program book ad (\$75 value), 2 President's Banquet tickets (\$120 value), and recognition at the President's Banquet.

Gold Education Fund Sponsor \$600

Funds are used for education of members.

Thank you for considering a WSNA sponsorship. Your generous contributions allow us to continue to offer quality programs to our members, and we are grateful

Although WSNA (Federal ID #23-7404031) is a not-for-profit organization, donations to WSNA are not tax deductible as gifts to a non-profit organization.

Level 3 Sponsorships (\$1,000 & above)

In addition, sponsors will also receive their logo on the WSNA website, a full-page black-and-white program book ad (\$100 value), 2 President's Banquet tickets (\$120 value), and recognition at the President's Banquet.

Breakfast Sponsor (3 available) \$1,250

Sponsor one of three breakfasts at conference.

Presidents Banquet Sponsor (1 only) \$1,500

Sponsor the President's Banquet where the contributions of our members are recognized.

General Session Speaker (2 available) \$2,500

Sponsor a general session keynote speaker.

Other Sponsorship Opportunities (cont.)

Opportunities also exist for sponsorship of other WSNA events. Please check the appropriate box on the Exhibit Space Application/Contract and include the price of sponsorship with your registration fees. If you have any questions or need additional information, contact Marianne Culligan, 206.714.5832, waschoolnutrition@gmail.com

Industry Seminar Speaker Sponsor \$1,000

Deadline for this sponsorship is November 1, 2020.

Sponsor helps underwrite the cost of a keynote presenter. Sponsor will receive 2 complimentary registrations (including 1 display table) at Industry Seminar (\$260 value), recognition on the WSNA website and in 1 issue of the *Apple Press*, recognition at Industry Seminar, and 2 complimentary tickets and recognition at the President's Banquet at Annual State Conference (\$120 value).

The three sponsorships below include listing in the program of the event sponsored, listing on the WSNA website as a sponsor for the event, and listing on signs at the event.

Industry Seminar \$200

This annual one-day event is a networking and educational event for school food service directors and supervisors and industry members. This seminar includes educational presentations, tabletop displays, and networking time. Attendance is approximately 80 district directors and supervisors.

Fall Workshops (4 available) \$200

Two annual one-day events for the education of members. More than 300 members attend these workshops. Donations of speakers, food items, or door prizes may also be made.

Spring Workshop (4 available) \$200

Annual one-day event held in a central location for the education of members. Over 200 members generally attend this workshop. Donations of speakers, food items, or door prizes may also be made.

Service Kit

LCD Exposition Services is the 2020 exhibits decorator. You will receive an exhibitor's packet from LCD in June with instructions for ordering such items as furniture. (The facility is fully carpeted.) It will also include information on shipping and material handling; DO NOT ship anything directly to the hotel. DO NOT INCLUDE ANY LCD FEES WITH YOUR BOOTH/ADVERTISING PAYMENT TO WSNA.

Electrical Service

There will be NO electrical service provided as part of your basic booth package. Those exhibitors who require electrical service will order it from the Spokane Public Facilities District on a form that will be included with the confirmation letter you receive from us in June.

Hotel

Doubletree Hotel, Spokane City Center
322 North Spokane Falls Court, Spokane, Washington 99201
Phone: (509) 744-2363 or Toll Free (800) 222-8733

Rates: Single/Double: \$135; \$10 each additional person. You may also reserve your rooms online by going to <http://bit.ly/2Gr94cK>

Reservation deadline is July 3, 2020. Please ask for the group rate for the Washington School Nutrition Association Annual Conference.

Annual Auction

WSNA's goal is to promote nutritious meals for children by placing a strong emphasis on the continuing education of school food service professionals in our state. One of the ways we fund this effort is by our auction that takes place at our Annual State Conference. This year we will have both a silent and live auction. You can help us meet our goal with a donation of an item. In that way, you play a direct role in contributing to the professional growth of all school food service employees. If you are interested in donating an item, please mark the appropriate square on the Exhibit Space Application/Contract.

Advertising

A limited number of black-and-white advertisements will be published in this year's program book. **Deadline for reserving ad space is May 15, 2020, and artwork must be received by June 1, 2020.**

Advertisement	Trim Size	Cost
Full Page	4 3/4" W x 7 1/2" H	\$100
Half Page	4 3/4" W x 3 3/4" H	\$ 75
Quarter Page	2 3/8" W x 3 3/4" H	\$ 50

Complete the Advertising Section of the Application/Contract or contact Marianne Culligan, 206.714.5832, waschoolnutrition@gmail.com, to reserve your space.

Official Decorator

LCD Exposition Services
PO Box 4487
Spokane, WA 99220
509.325.9656

Door Prize Donations

Vendors who wish to contribute "extra" can do so by offering items as door prizes. Please complete the appropriate section of the Application/Contract. *Those responding by July 1 will receive recognition in the Conference program book.*

Terms and Conditions of Exhibit Space Agreement

Eligible Exhibits: The Washington School Nutrition Association (WSNA) reserves the right to determine the eligibility of any company or product to exhibit in WSNA's State Conference Exhibits and further reserves the right to reject any application and/or limit space assigned to any one company. Show management also has the right to stop exhibiting companies from the showing of products or services which would negatively impact the show's reputation.

Limitation of Liability: The exhibitor agrees to make no claim for any reason whatsoever against WSNA and/or Spokane Convention Center wherein the exhibits are held, for loss, theft, damage or destruction of goods, nor for any injury to himself or employees while exhibits are in progress, being set up or dismantled. Exhibitor agrees to indemnify and hold harmless WSNA, Spokane Convention Center and their employees, against any and all claims of any person, arising out of acts, omissions or negligence of exhibitor, its agent or employees. Organizer makes no warranties regarding the number of persons who will attend the event. If any term of this agreement is declared invalid or unenforceable, the remainder shall continue in full force and effect. Any action arising out of this agreement of the Event shall be brought in Spokane County, Washington, and governed by the law of that locale, exclusive of the choice of law rules of any jurisdiction. Organizer shall be entitled to recover reasonable attorney's fees and costs in any action to enforce this Agreement.

Limitation of Exhibits: WSNA reserves the right to stop or remove from the exhibits any exhibitor, or his representative, performing an act or practice which in the opinion of WSNA is objectionable or detracts from the dignity of the exhibits or is unethical to the business purpose of the exhibits. **WSNA reserves the right to refuse admittance of exhibits or materials to the exhibits until all fees owing are paid in full. No exhibitor shall hold any social event or entice WSNA members off the exhibit floor during official exhibit events or during scheduled conference events (as printed in Conference at a Glance).**

Assignment of Space: After priority is given to WSNA Platinum Partners, assignment of space is made on a **paid** first come, first served basis by date. No assignment of space will be made or held unless full payment accompanies the request for space.

Registration/Name Badges: Registration packets and name badges will be distributed on show site on day of set-up.

Cancellation or Withdrawal: Cancellation of space and refund is subject to the following conditions: Exhibitors shall give written notice of cancellation. If written notice is received more than 60 days prior to Exhibits (May 29, 2020), total monies less \$100 cancellation fee will be refunded to Exhibitor. No refunds will be allowed for any cancellation less than 60 days prior to the opening of exhibits.

Exhibit Restrictions: No exhibitor or part of an exhibit will be admitted to any space until rental of that space has been paid in full. Actual selling of products from the exhibit floor is prohibited. **No exhibitor may begin dismantling his exhibit until AFTER the closing hour of exhibits.** The exhibitor shall properly staff the exhibit during exhibit hours. Exhibitors are liable for any damage caused to building walls, floors or columns or other exhibitors' property. Vendors for whom WSNA makes exhibit space available are those who have products/services that are of interest and use to the school food service industry. The acceptance of an exhibiting firm does not constitute an endorsement or approval by WSNA of the quality or value of claims made by the firm. Foods of minimal nutritional value should not be shown at exhibits. These include carbonated beverages (unless approved by USDA for use in child nutrition programs), chewing gum, some water ices, certain candies, jellies and marshmallow candies, fondant, licorice, spun candy and candy-coated popcorn.

Boundaries: All parts of all exhibits must be exhibited within exhibitor's assigned space boundaries. Aisle space is under the control of WSNA.

General Show Policies: Noisy or offensive exhibits are prohibited. **Children under the age of 16 are not permitted in the exhibit hall. Any exceptions must be cleared through WSNA.** Distribution of literature or samples must be related to exhibit and distribution limited to within exhibitor's space. Assignment or subletting of assigned space by exhibitor is not permitted for any reason without approval of WSNA. Exhibitor must comply with all local laws, rules, regulations and ordinances in force. The exhibitor may not display signs that are not professionally prepared or in the opinion of WSNA detract from the appearance of the exhibits in any manner whatsoever. The Exhibits Manager shall have sole control over all admission policies at all times.

Termination of Show: If WSNA determines the premises where the exhibits are to be held has become unfit for occupancy, or if the premises are materially interfered with by any reason of strike, embargo, injunction, act of war, act of God, act of terror, any other emergency, or any act or event not the fault of WSNA, this agreement may be terminated by WSNA. In the event of such termination, the exhibitor waives any and all damages to WSNA.

Relocation of Exhibits: WSNA reserves the right to alter the official floor plan, and/or reassign any exhibitor's location as deemed advisable. WSNA further reserves the right to make such changes, amendments and additions to these rules and such further regulations as it considers necessary to act in the best interest of the exhibits.

Booth Construction and Show Services: Standard booths are limited to 8 ft. background drapes and 3 ft. high side drapes. Maximum height of standard exhibit is 8 ft. and may extend only one-half the booth depth from the back wall. Height in the front half of the exhibit space cannot exceed 3' high, except for product height which may exceed the 3' height limitation. Booth decorations, additional furniture, additional signs and electrical connections are available to the exhibitor through independent contractors who will directly bill the exhibitor. WSNA is not responsible for any service provided by independent contractors.

Collection Policy: The exhibitor agrees to pay any and all cost incurred by WSNA to collect any portion of fees due and owing to WSNA not paid in full prior to the opening of the exhibits.

Security: Security guards will be furnished by WSNA overnight Monday and in the exhibit hall during show hours.

Insurance: Each exhibiting company must provide a certificate of insurance in the amount of **\$1,000,000 per occurrence/\$2,000,000 aggregate and naming WSNA as an additional insured. Proof of insurance should be received by July 1, 2020.**

Cooking Regulations: Cooking and/or warming devices producing grease laden vapors shall be electric. Exception: Approved cooking devices that use no more than (2) 10-ounce non-refillable LPG containers having a maximum water capacity of 1.08lb per container connected directly to the appliance at any time, shall be allowed. Sterno may be used for warming trays. Other open flame devices are prohibited. Cooking devices shall be approved by a recognized testing laboratory (i.e. UL or FM) Fire protection shall be provided with any booth utilizing cooking/warming devices **with no** vegetable or animal oils and fats, and each device must be **either** (1) a 20B:C extinguisher and a lid for smothering, or (2) an approved automatic extinguishing system (hood system). Fire protection shall be provided with any booth utilizing cooking/warming devices cooking **with** vegetable or animal oils and fats, and each device must be **either** (1) a Class K fire extinguisher and a lid for smothering, or (2) an approved automatic extinguishing system (hood system).

Exhibit Space Application/Contract

WSNA Annual Conference Exhibits

July 28, 2020
Spokane Convention Center West
Spokane, Washington

I. Company Information

Company _____

Address _____

City _____ State _____ Zip _____

Area Code _____ Phone # _____

Fax # _____

II. Exhibitor Contact

Contact Name _____

Area Code _____ Contact Phone # _____

Contact Fax # _____

Contact Email Address _____

Address (if different than above) _____

City _____ State _____ Zip _____

Website Address _____

III. Broker (if applicable)

Broker Name _____

Will you exhibit with your broker? Yes No

IV. Booth Preference

1. _____ 2. _____ 3. _____

To whom do you **NOT** want to be next? _____

Booths are assigned on a paid first-come, first-served basis.

IV. Payment

Check (enclosed) Visa MasterCard AmEx Discover

Credit Card # _____

Security Code _____ Exp. Date _____

Name on Card _____

If credit card address and zip code differ from Section I, please provide information as it appears on credit card billing:

Address: _____ ZIP _____

A \$15 fee will be assessed for returned checks.

V. Authorization (REQUIRED FOR ALL)

Each exhibiting company must provide a certificate of insurance in the amount of \$1,000,000 per occurrence/\$2,000,000 aggregate that names WSNA as an additional insured on the policy AND provide an authorized signature below. Proof of insurance should be received by WSNA by July 1, 2020. Authorized Signature indicates acceptance of and agreement to abide by the official Terms and Conditions, the booth payment schedule and to all conditions under which exhibit space is leased to WSNA. If paying by credit card, signature authorizes payment. Please contact Peggy Rieper, wsnaexec@comcast.net, if you have questions.

Signature _____

Date _____

VI. Other Donations

We are very grateful for the generous donations of our industry friends. If you are interested in this way, please place a ✓ in any of the following for which you would like to make a donation. You will receive recognition in our quarterly newsletter and at the event.

Item:	Event			
	Conference	Fall Wkshp	Ind Sem	Spring Wkshp
Speaker	<input type="checkbox"/>	<input type="checkbox"/>	<input type="checkbox"/>	<input type="checkbox"/>
Door Prizes	<input type="checkbox"/>	<input type="checkbox"/>	<input type="checkbox"/>	<input type="checkbox"/>
Food/Supplies	<input type="checkbox"/>	<input type="checkbox"/>	<input type="checkbox"/>	<input type="checkbox"/>
Cash Donation	<input type="checkbox"/>	<input type="checkbox"/>	<input type="checkbox"/>	<input type="checkbox"/>

We will contact you regarding any donation marked above.

Please send your application with appropriate payment to:

WASHINGTON SCHOOL NUTRITION ASSOCIATION
c/o Marianne Culligan

26267 W. Via Del Sol Drive. Buckeye, AZ 85396
(206) 714-5832 ~ waschoolnutrition@gmail.com

Tax ID #: 23-7404031

VII. Order

Booth Space

_____ Booth(s) @ \$1050 _____

_____ Nonprofit booth(s) @ \$ 300 _____

_____ Late Fee* @ \$ 50 _____

*Payment after May 10, 2020 add \$50 per booth

Booth Space Total \$ _____

Please refer to Cancellation or Withdrawal section on page 6 for refund information.

Advertising

Full page \$ 100

Half page \$ 75

Quarter page \$ 50

Advertising Total \$ _____

Sponsorships (see pages 4 and 5)

Bronze Education Fund (inc. 1/4 page ad) \$ 300

Silver Education Fund (inc. 1/4 page ad) \$ 400

Promotional Inserts (inc. 1/4 page ad) \$ 300

Wellness Events Sponsor (inc. 1/4 page ad) .. \$ 300

Gold Education Fund (inc. 1/2 page ad) \$ 600

Industry Seminar Speaker \$ 1,000

Breakfast Sponsor (inc. full page ad) \$ 1,250

President's Banq. Sponsor (inc. full page ad) \$ 1,500

General Session Speaker (inc. full page ad)... \$ 2,500

Platinum Partner (inc. full page ad) \$ 3,800

*Fall Workshop Sponsor \$ 200

*Spring Workshop Sponsor \$ 200

Industry Seminar Sponsor \$ 200

Individual Industry Dues (see insert) \$ 40

Corporate Industry Dues (see insert) \$ 160

Sponsorship Total \$ _____

Total Due (Booth + Advertising + Sponsorships) \$ _____

* If you wish to donate speakers, food items or door prizes, please indicate in Section VI, Other Donations.

Although WSNA (Federal ID #23-7404031) is a not-for-profit organization, donations to WSNA are not tax deductible as gifts to a non-profit organization.

2019 WSNA Conference Exhibitors

Acosta Sales & Marketing*

Affinity ~ Elite
 Ajinomoto
 Albies
 Amazing Fruit
 American Produce Express
 Amplify
 Apple & Eve
 Aryzta (Otis)
 Asian Food Solutions
 At Your Services Sales
 Auburn Dairy~Yami
 B & D Foods
 Bake Crafters
 Baker Boy
 Barfresh
 Bargreen Ellingson
 Basic American
 Bongards
 Bonzer's
 Bridgford Foods
 Brittain Associate
 Brookwood Farms
 Buena Vista Foods
 Butter Buds
 C. H. Guenther
 Campbell's
 Cargill
 Carlisle~RHI Solutions
 Chef's Corner
 Cloverdale Meates
 Coastal Marketing
 Comida Vida
 ConAgra Foodservice
 Country Pure Foods

Daisy
 Dakota Growers
 Darlington Snacks
 Dave's Baking
 David's
 Del Monte
 Del Real Foods
Desert Peak Marketing*
 DeWafelbakker
 Diamond Crystal Brands
 Dole Foods
 Domino's Smart Slice
 Dr. Praeger's Sensible Foods
 Duck Delivery Produce
 Envy
 ES Foods
 Fabri-Kal
 Fieldstone Bakery
Food Services of America*
Foster Farms*
 Franz Bakery
 Fresca Foods
 Fresh Innovations
 Garner Foods~Texas Pete
General Mills*
 Harvest Hill
Health-e Pro*
 Heartland Food Products Group
 Heartridge Farms
 Heritage Specialty Foods
 Highliner
Hobart Corporation~ITWFEG*
 Horizon Software International
 Idaho Pacific
 Idahoan

Integrated Food Service
 IPS Rebates
 J & J Snacks
 J. R. Simplot
 Jack Link's Beef Jerky
JG Neil & Company*
 JM Smucker Company
 JohnSoules~Proview Foods
 Jones Dairy
JTM Food Group*
 Kellogg's
 Kelly-Mincks
 Kent Precision Foods Group
 KeyImpact Sales & Systems
 Kikkoman
 Kraft Heinz Company
Land O Lakes*
 Litehouse
 Longhorn Barbecue
 Magic Seasonings
 Major Products
 MarkeTeam Foodservice
 Marzetti
 McCain
 MCI~Los Cabos
 McKee
 Mealtime~The CLM Group
 Michael Foods
 Mission Food Service
 MJM Marketing
 Mott's
 Muffin Town
 Nardone Brothers Baking
 Nathan's Famous Franks
National Food Group*

NORPAC Foods
 Ocean Spray
 Oliver Packaging & Equipment Co.
 OSPI
 P & R Paper Supply Co.
 Pacific Coast Producers
Pacific Support Systems~SFS Pac*
 Pan Saver~M & Q Packaging
 Parway Tryson
 Pathwater
 Penny's Salsa
 PepsiCo Foodservice
 Performance Reps NW
Peterson Farms Fresh, Inc.*
 Pilgrim's~Goldkist
 Popcorn Indiana
 Post Consumer Brands
 PrimeroEdge
 Pro-Pacific Agents
 Red Gold
 Rich Chicks
Rich Products*
 Right Start
 Rose & Shore
 Ruiz
 S. A. Piazza
 Safe & Fair Food Company
 Sara Lee
Schwan's*
 Shannon's
 Sky Blue Bakery
Smith & Greene Co.*
 Smithfield
Spokane Produce*
 Starkist

Sun Maid
 SunButter
 Super Bakery
 Superior Foods
 Talking Rain
 Tasty Brands
 TekVisions, Inc
 Terry's Dairy
 The CORE Group
 The Father's Table
 The Platinum Packaging Group
 The Tony Roberts Company
 TITAN School Solutions, Inc.
 TMI Trading
 Tools for Schools
 Tree Top
 Trident
 Tyson Foods
 Uncle Ben's
 UNOX
 USA Pears
 Vibrant Health
Voeller & Associates*
 WA Red Raspberry Commission
 WA State Beef Commission
WA State Dairy Council*
WA State Potato Commission*
 Wawona Frozen Food
 Waypoint
 Well's/Blue Bunny
 World Centric
 WOW Butter
 WSDA Farm to School
Yang's 5th Taste*

*2019 WSNA Sponsor

WASHINGTON SCHOOL NUTRITION ASSOCIATION

July 28, 2020

Spokane Convention Center West
 Spokane, WASHINGTON